

# Your Crochet Flower Bag



*Size:* 27 x 30 cm without handle, 45 x 30 cm with handle



## All you need from **PONY**:

### **SLICK Crochet Needle set:**

8 crochet hooks in sizes 2.00 mm, 2.50 mm, 3.00 mm, 3.50 mm, 4.00 mm, 4.50 mm, 5.00 mm, 6.00 mm, interchangeable Easy Grip Handle, 2 Aluminium Wool needles, 10 Safety Stitch Markers.

**In Addition:** Chenille Colour Eye Needles, Wool Needles, Pearlised head pins, Crafts Scissors.



Use the interchangeable Easy Grip Handle for all the crochet hooks in the set. Easy to assemble.



The **Slick-Set** provides the colourful Stitch Markers and the Aluminium Wool Needles in two sizes and a needle gauge as a **Bonus for you** incorporated into the lid.

## What else:

200 g Cotton Yarn in light grey for the bag ( 50g/80 m); Use a slightly thinner yarn (50 g/90 m) for the flowers, 50 g each of dark grey, green, denim blue and light purple. 1 pair of sew-on handles in black, 18 cm metal zipper in grey, 10 pearls in silver grey of 10 mm Ø; Sewing thread in matching colours.



## Stitch sample:

16 stitches x 20 rows = 10 x 10 cm, using light grey cotton yarn

## How to start :

1. Start with 39 chain stitches using light grey cotton yarn and a 4,5 mm crochet hook. Plus 1 extra chain stitch when turning at the end.
2. Start with the second chain from the needle and make single crochet stitches until the end of the chain and end with 4 single crochet stitches into the last chain. This will become your round bag base. Repeat single crochet stitches on the other side of your chain with again 4 single crochet stitches in the last chain stitch. Base rounding = 84 single crochet stitches. Finish the round with a slip stitch. Mark the beginning and the end of the round (the 4 single crochet stitches are in between) on both sides using the stitch markers.



3. Continue with single crochet stitches forming the rounds. Mark the start of each row. The base of the bag needs 3 rounds. **Second round** add 4 stitches on each side: 2 single crochet stitches into the 4 single crochet stitches of the previous round = 8 single crochet stitches on each rounding = 92 stitches total. Remove the stitch markers from the previous round and place them into both curves. **Third round** add 4 stitches on each side: one single crochet stitch into the first stitch of the curve (previous round), 2 single crochet stitches into the second stitch, 2 single crochet stitches into the third stitch and only one single crochet stitch into the fourth and fifth stitch, 2 single crochet stitches into the sixth stitch, 2 into the seventh, one into the eighth stitch = 100 stitches. Remove the stitch markers from the previous round and place them into both curves. **Fourth row** now stitch 2 x 2 single crochet stitches together in both curves like this: one single crochet stitch into the first and second stitch of the curve, 3rd and 4th stitch together, one into the 5<sup>th</sup> – 8<sup>th</sup> stitch. 9th and 10th stitch together. One into the 11<sup>th</sup> and 12<sup>th</sup> stitch = 96 single crochet stitches. By doing this the stitches curve up. Continue until you measure 21 cm from the bottom = 42 rounds of single crochet stitches. .

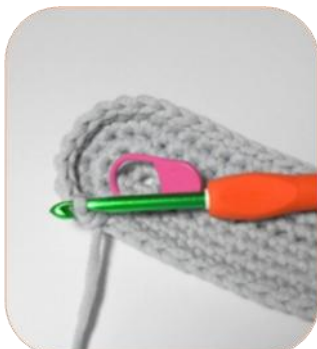

**4.** To make the zipper slot , place the bag flat onto your table. One length is made of 48 single crochet stitches. Mark the 9<sup>th</sup> single crochet stitch with a stitch marker. 30 single crochet stitches are in between. Make single crochet stitches up to the first stitch marker, now make 30 chain stitches and stitch again into the second marking. Finish the row with single crochet stitches. Now start the next row with single crochet stitches and make 30 single crochet stitches into the 30 chain stitches. Continue 5 cm = 10 rows. The bag is ready once you have reached the top blue stitch stopper, starting from the stitch marker on the bottom of the bag (pink stitch stopper) . Do not cut the thread.

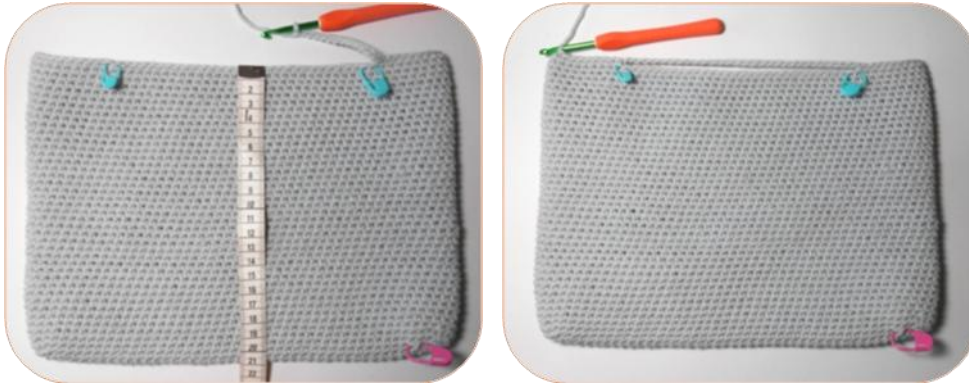

**5.** Finish the top row with chain stitches.



**6.** Now attach the handles and place the bag flat onto your table. 4 cm from each side will be your position for sewing the handle onto the bag. Use the PONY wool needle and the cotton yarn and start stitching through the holes of the handle. The wool needle has a large, flexible eye which accommodates your yarn. .

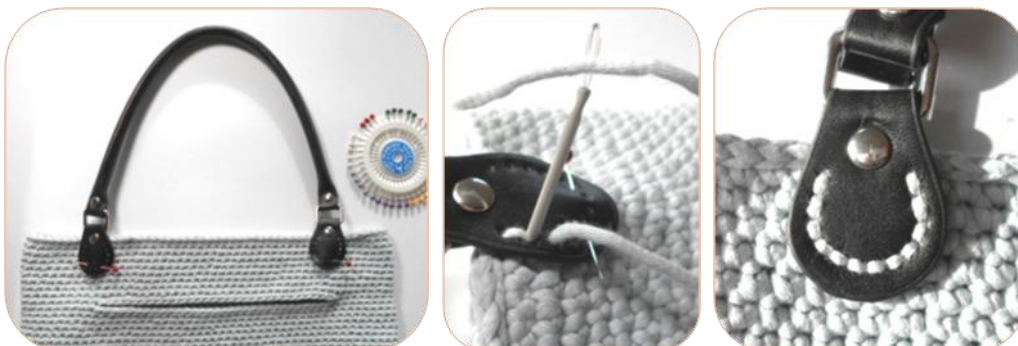

7. Now to insert the zipper. Place it in the right position underneath the slot and sew it onto your bag using saddle stitches. You may also use a sewing machine. .



8. For the pocket pouch we recommend you use the the same colours you use for the flower colours. This way you do not have any left overs. Make 44 chain stitches = 24 cm using needle size 3,5 mm and green yarn. Make single crochet stitches for 15 cm = 22 rows. Now continue with dark grey and start the first row with back loops. Continue with 22 rows of single crochet stitches in dark grey, 4 rows in denim blue. Now fold the pouch so that the blue overlaps and sew together starting at the long side. Make two single crochet stitches at the upper right corner and also all the way along the blue edge. Again two single crochet stitches in the left corner. Now crochet the left sides together.



1. Pocket pouch, front, crocheted together.
2. Blue top edge, turned, green short side can be seen.
3. Pocket pouch, reverse, sew all threads with the pointed wool needle.

9. Now centre the pocket pouch above the zipper and sew the reverse onto the lower part of the zipper, and the front above the zipper. Now sew the pouch 3 cm from left and right.

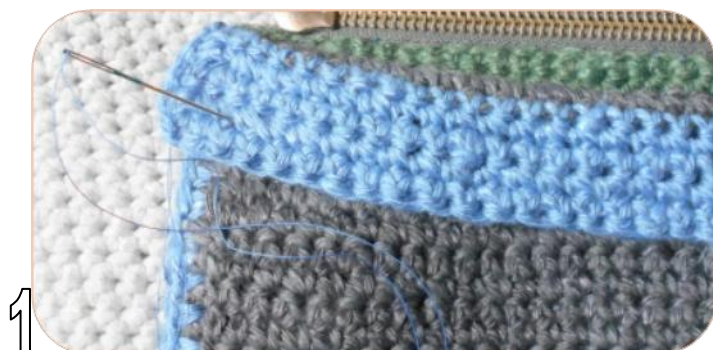

1. Pouch reverse sewn
2. Pouch completely sewn
3. View of pouch from outside. Zipper opens easily. Flower, see further down).

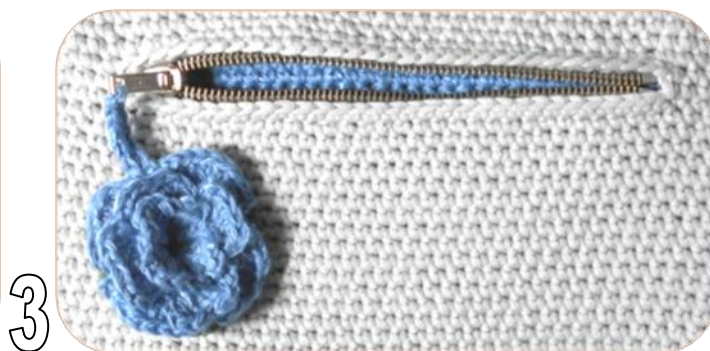

## Crochet Flowers:

1. Make two flowers in two colours. 6 chain stitches using needle size 3,5 mm and close to a ring with a slip stitch. 1 single crochet stitch, 2 chain stitches, 3 double crochet stitches, 2 chain stitches, 1 single crochet stitch around the ring = 1 flower petal.

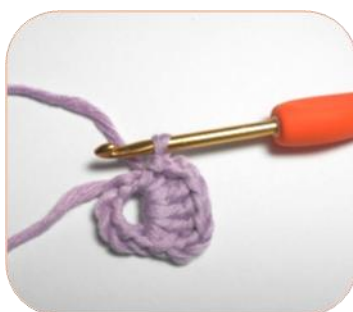
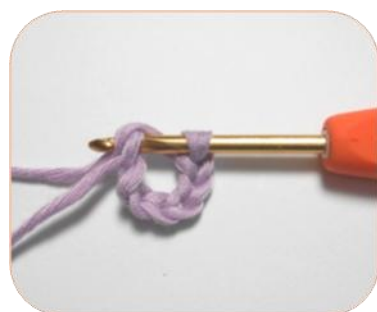

2. \*2 chain stitches, 3 double crochet stitches, 1 single crochet stitch\* Repeat from \* to \* three times = 5 flower petals. However, close the last round with a slip stitch instead of a single crochet stitch.

**3.** Continue on the reverse of the flower with 2 slip stitches until the centre = back loop half double crochet. 3 chain stitches and 1 slip stitch into the next centre. \* 3 chain stitches, 1 slip stitch into centre. Repeat five times from \*to \* One slip stitch at the end.



**4.** One single crochet stitch in each chain stitch, 1 chain stitch, 5 double crochet stitches, 2 chain stitches, 1 single crochet stitch.



**5.** Finish all the flowers and continue on the reverse as explained under 3. However each loop requires 4 chain stitches. In every chain space as described under point 4 crochet one one flower petal using 7 double crochet stitches for every petal. Sew the thread ends with the wool needle.

*Left image:* This is the second row of flower petals from the reverse.

*Middle image:* This is the ready chain space.

*Right image:* Four flower petals are ready.



*Left image:* Third row of flower petals, four petals are done, from the left.

*Middle and right image:* Flower from the front and the reverse.



**6. Zipper:** Crochet two flowers in different colours making each 4 petals. One flower making two rows as described above. Do not cut the thread on one flower and make 8 chain stitches. Using a crochet hook size 2,5 mm from your SLICK SET go through the zipper hole and fix the flower. Now one single crochet stitch back to the flower. Sew the second flower against the first one and attach a pearl in the centre of each side.

## Complete the bag

**1.** Sew all loose thread ends on bag and flowers. Put the flowers in place and fix them with pins. Now sew each flower with a matching sewing thread on to the bag. Start sewing from the centre of the flower and also inbetween the petals. When you are done sew a pearl onto the centre of every flower. .



The colour eye needles have a small eye and will accommodate the small pearls.

